



glentree  
RENTALS

020 8209 1144  
www.glentree.com



## Sheldon Avenue, N6

Charming 5 bedroom double fronted detached house offering family accommodation over three floors, wood floors throughout the ground floor and outdoor swimming pool

Lounge, dining room, study, kitchen/breakfast room, utility room, guest cloakroom, master bedroom with dressing room and bathroom, 4 further bedrooms, 2 further bathrooms (1 ensuite), landscaped rear garden with outdoor swimming pool, single integral garage, off-street parking

Available unfurnished.

EPC Rating D.

**£3,995 Per Week**

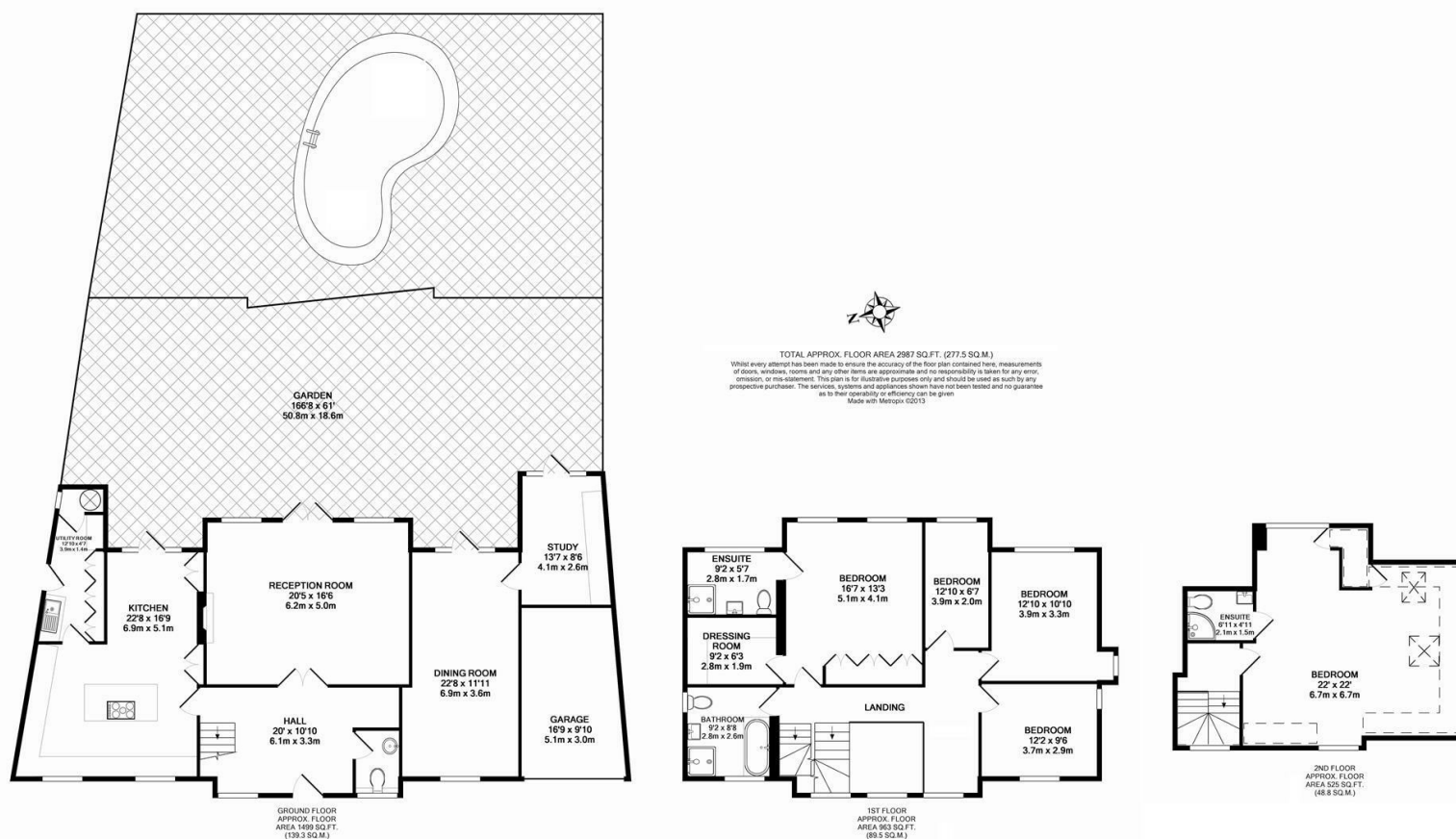

RENTALS 020 8209 1144  
SALES 020 8458 7311  
FAX 020 8209 0307

E rentals@glentree.com  
E sales@glentree.com  
W www.glentree.com

Glentree Estates Ltd  
698 Finchley Road  
London NW11 7NE



